

B-500
B-574

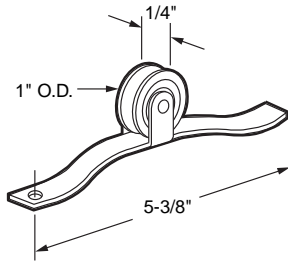

B-501
B-502

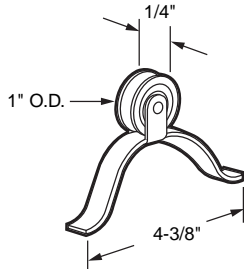

B-503
B-678

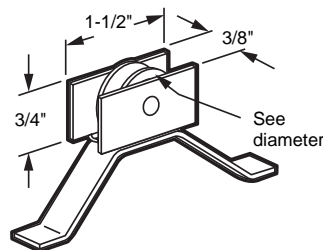

B-625

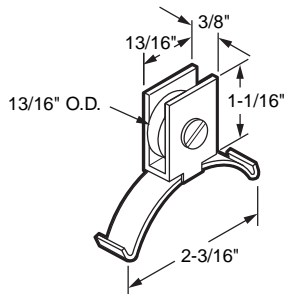

B-504
B-505

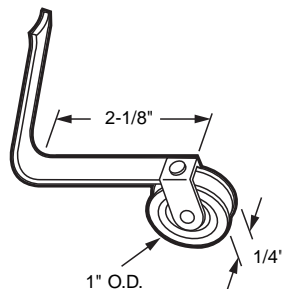

B-506
B-572

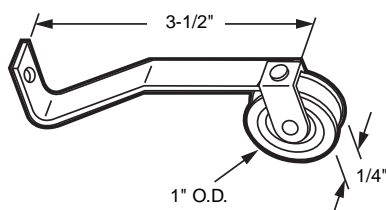

B-574 (Nylon)
B-500 (Steel ball bearing)
Spring Tension Roller

Contents: 2 roller assemblies; installation screws.

Description: Wheel with center groove; heat treated, high tension steel spring.

B-501 (Nylon)
B-502 (Steel ball bearing)

Spring Tension Roller

Contents: 2 roller assemblies.

Description: Wheel with center groove; heat treated, high tension steel spring.

B-503 (Nylon - 7/8")
B-678 (Steel ball bearing - 1")

Spring Tension Roller

Contents: 2 roller assemblies.

Description: Wheel with center groove; aluminum housing; heat-treated, high tension steel spring; can be used as a top or bottom roller; fits on *Keller* doors.

You may wish to stock these related parts: **A-122**.

B-625

Spring Tension Roller

Contents: 2 roller assemblies.

Description: 13/16" flat nylon wheel, nylon housing; high tension steel spring; aluminum axle; can be fits as a top or bottom roller on *Croft* doors.

B-504 (Nylon)
B-505 (Steel ball bearing)

Spring Tension Roller

Contents: 2 roller assemblies.

Description: Wheel with center groove; heat treated, high tension steel spring.

You may wish to stock these related parts: **B-533**.

B-572 (Nylon)
B-506 (Steel ball bearing)
Spring Tension Roller

Contents: 2 roller assemblies; installation screws.

Description: Wheel with center groove; heat treated, high tension steel spring.

Sliding Screen Door

B-507 (Nylon)
B-508 (Steel ball bearing)

Spring Tension Roller

Contents: 2 roller assemblies.

Description: Wheel with center groove; heat treated, high tension steel spring.

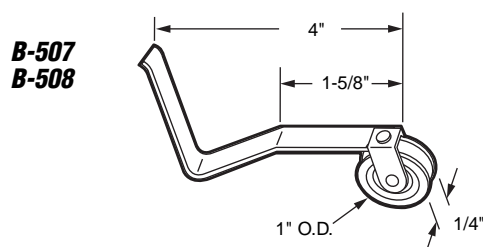

B-509 (Nylon)
B-510 (Steel ball bearing)

Spring Tension Roller

Contents: 2 roller assemblies.

Description: Wheel with center groove; heat treated, high tension steel spring.

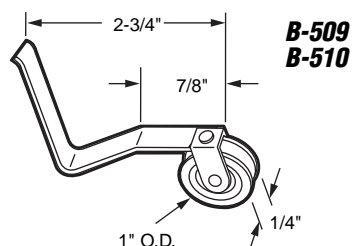

B-698 (Nylon)
B-699 (Steel ball bearing)

Spring Tension Roller

Contents: 2 roller assemblies.

Description: Wheel with center groove; heat treated, high tension steel spring.

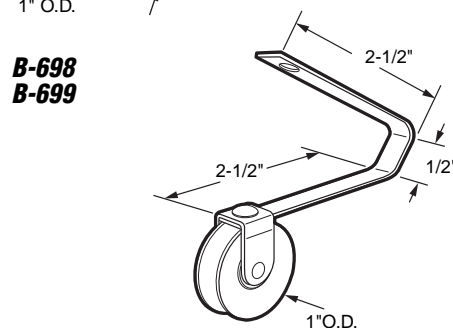

B-570 (Nylon)
B-571 (Steel ball bearing)
B-688 (Nylon ball bearing)

Spring Tension Roller

Contents: 2 roller assemblies.

Description: Wheel with center groove; heat treated, high tension steel spring; used by several patio door manufacturers.

You may wish to stock these related parts: **B-623**.

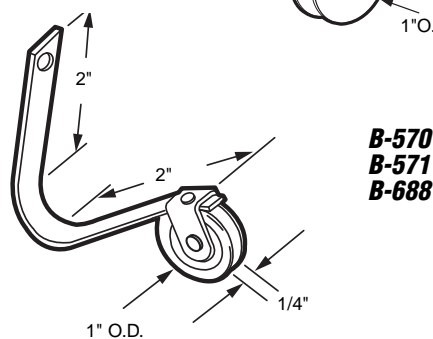

B-512 (Nylon)
B-513 (Steel ball bearing)
B-632 (Nylon - offset groove; 1 left & 1 right)
B-640 (Nylon ball bearing)

Spring Tension Roller

Contents: 2 roller assemblies.

Description: Adjustable, wheel with center groove; heat treated, high tension steel spring; used by several patio door manufacturers.

You may wish to stock these related parts: **A-108, A-125, B-623**.

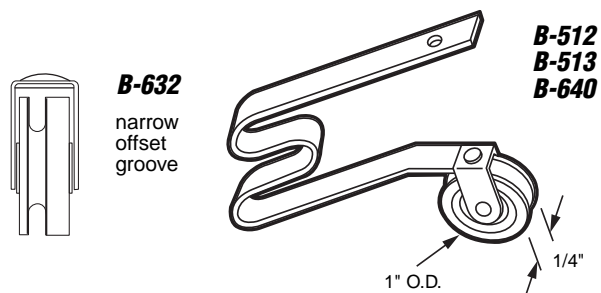

B-643 (Nylon)
B-644 (Steel ball bearing)

Spring Tension Roller

Contents: 2 roller assemblies.

Description: Adjustable, wheel with center groove; heat treated, high tension steel spring; 1/8 inch locator pin holds roller in fixed position; used by several patio door manufacturers.

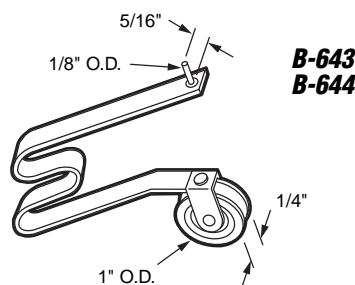

B-514
B-636

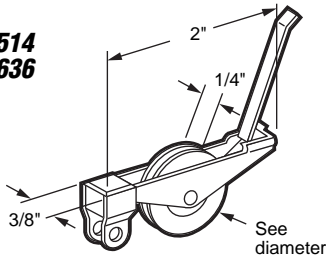

B-515
B-541
B-610

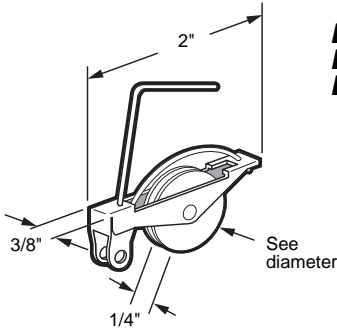

B-518
B-608
B-654

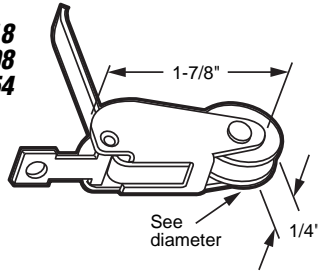

B-637

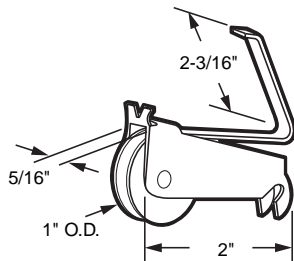

B-521
B-522
B-685

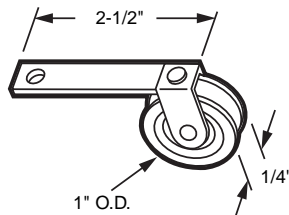

B-523
B-524

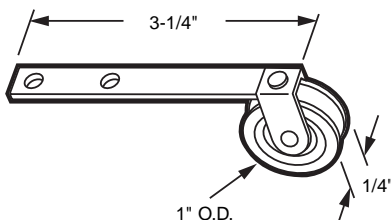

B-514 (1" nylon)
B-636 (1-1/4" nylon)

Spring Tension Roller

Contents: 2 roller assemblies.

Description: Wheel with center groove; **steel housing**; heat treated, high tension **steel spring**; used as top and bottom roller.

B-515 (1-1/4" nylon)
B-541 (1" nylon)
B-610 (1" steel ball bearing)

Spring Tension Roller

Contents: 2 roller assemblies.

Description: Wheel with center groove; **steel housing**; heat-treated, high tension **steel spring**; used as a top and bottom roller.

You may wish to stock these related parts: **A-111, A-119, A-121, A-139, B-514, B-569, B-636.**

B-518 (1" nylon)
B-608 (1" steel ball bearing)
B-654 (1-1/4" nylon)

Spring Tension Roller

Contents: 2 roller assemblies; self-tapping installation screws.

Description: Wheel with center groove; **steel housing**; heat-treated, high tension **steel spring**; used as a top and bottom roller.

B-637

Spring Tension Roller

Contents: 2 roller assemblies.

Description: Nylon wheel with center groove, **steel housing**, high tension **steel spring**.

B-521 (Nylon)
B-522 (Steel ball bearing)
B-685 (Nylon ball bearing)

Spring Tension Roller

Contents: 2 roller assemblies; installation screws.

Description: Wheel with center groove; heat treated, high tension **steel spring**.

B-523 (Nylon)
B-524 (Steel ball bearing)

Spring Tension Roller

Contents: 2 roller assemblies; installation screws.

Description: Wheel with center groove; heat treated, high tension **steel spring**.

You may wish to stock these related parts: **A-114, B-534.**

Call for
Availability

Sliding Screen Door

B-525 (Nylon)

B-526 (Steel ball bearing)

Spring Tension Roller

Contents: 2 roller assemblies; installation screws.

Description: Wheel with center groove; heat treated, high tension steel spring.

You may wish to stock these related parts: **A-114, B-534.**

B-525
B-526

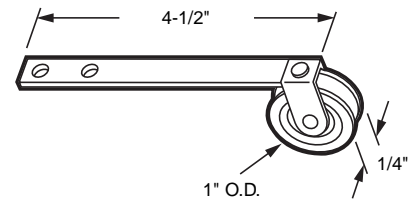

B-527 (Nylon)

B-528 (Steel ball bearing)

Spring Tension Roller

Contents: 2 roller assemblies; installation screws.

Description: Wheel with center groove; heat treated, high tension steel spring.

You may wish to stock these related parts: **A-113, B-537.**

B-527
B-528

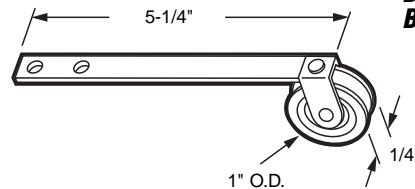

B-635 (Nylon)

B-666 (Steel ball bearing)

Spring Tension Roller

Contents: 2 roller assemblies; installation screws.

Description: Wheel with center groove; heat treated, high tension steel spring; with angle stops; used by many door manufacturers.

You may wish to stock these related parts: **A-113, B-537.**

B-635
B-666

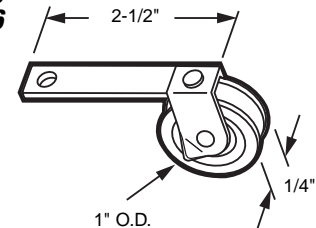

B-661 (Double spring)

B-662 (Triple spring)

*Call for
Availability*

Spring Tension Roller

Contents: 2 roller assemblies; installation screws.

Description: Nylon wheel with center groove; heat treated, high tension steel spring; uses two or three springs to increase tension; fits on doors by *Academy Mfg. Co.*

B-661
B-662

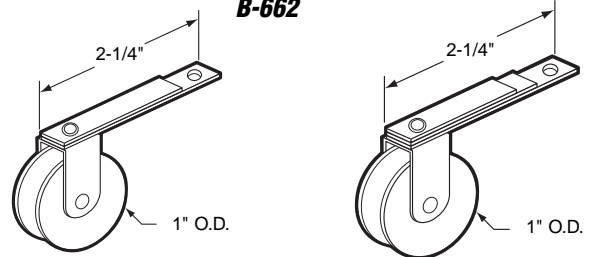

B-576 (Steel ball bearing)

B-609 (Nylon)

B-686 (Nylon ball bearing)

Spring Tension Roller

Contents: 2 roller assemblies; installation screws.

Description: Wheel with center groove; heat treated, flat, high tension steel spring; bent spring design; fits on doors by *Academy Mfg. Co.*

You may wish to stock these related parts: **A-113, B-537.**

B-576
B-609
B-686

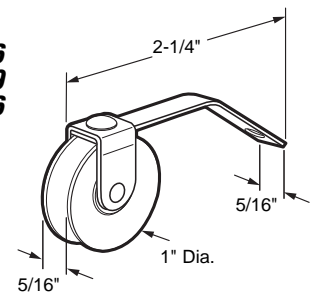

B-681

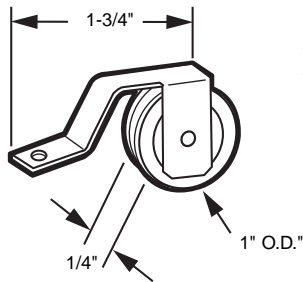
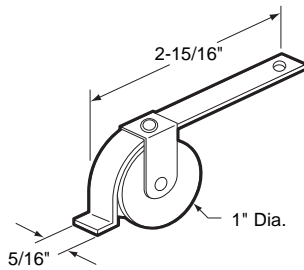

**B-638
B-639
B-687**

B-511

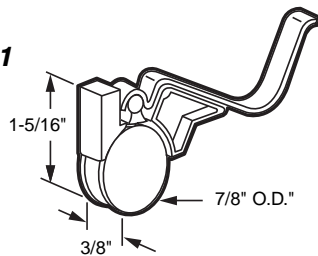

B-516

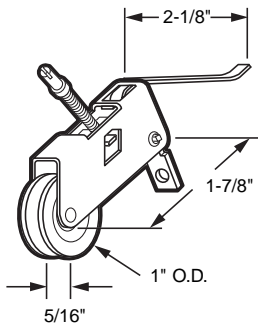

**B-517
B-689**

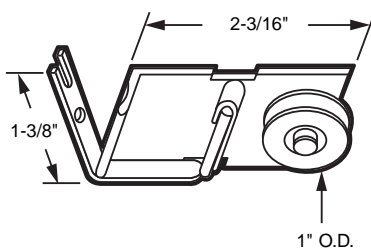

**B-634
B-690**

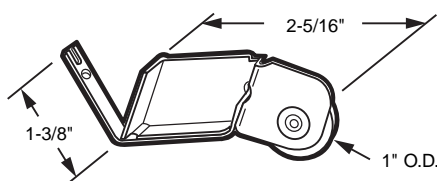

B-681

Spring Tension Roller

Contents: 2 roller assemblies.

Description: Nylon wheel with center groove; heat treated, high tension steel spring; fits on doors by *Academy Mfg. Co.*

You may wish to stock these related parts: **A-142, A-147.**

B-638 (Nylon)

B-639 (Steel ball bearing)

B-687 (Nylon ball bearing)

Spring Tension Roller

Contents: 2 roller assemblies; installation screws.

Description: Wheel with center groove; heat treated, high tension steel spring; fits on doors by *Metal Industries.*

You may wish to stock these related parts: **A-142, A-147.**

B-511

Spring Tension Roller

Contents: 2 roller assemblies.

Description: Nylon wheel and housing with open groove; heat treated, high tension steel spring.

You may wish to stock these related parts: **B-563.**

B-516

Spring Tension Roller

Contents: 2 roller assemblies.

Description: Adjustable, nylon wheel with center groove; steel housing; heat treated, high tension steel spring.

B-517 (Nylon)

B-689 (Steel ball bearing)

Spring Tension Roller

Contents: 2 roller assemblies; installation screws.

Description: Extruded aluminum housing, with steel spring; adjustable wheel with center groove. Fits on *International* series No. 900, 925, 950 doors.

You may wish to stock these related parts: **A-140, B-634.**

B-634 (Nylon)

B-690 (Steel ball bearing)

Spring Tension Roller

Contents: 2 roller assemblies; installation screws.

Description: Stamped aluminum housing, with steel spring; adjustable wheel with center groove. Fits on *International* series no. 900, 925, 950 doors.

You may wish to stock these related parts: **A-140, B-517.**

Sliding Screen Door

B-519

Spring Tension Roller

Contents: 2 roller assemblies.

Description: Nylon wheel with center groove; zinc diecast housing, heat treated steel wire loop; with extension spring.

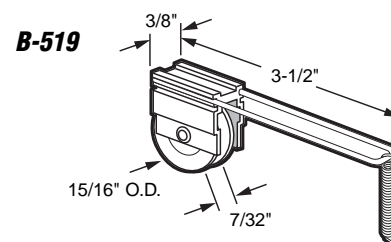

B-520

Spring Tension Roller

Contents: 2 roller assemblies.

Description: Nylon wheel with center groove; nylon guide roller; heat treated, high tension steel flat spring; fits as a top roller on *Arcadia* extruded aluminum doors.

You may wish to stock these related parts: B-560.

B-520

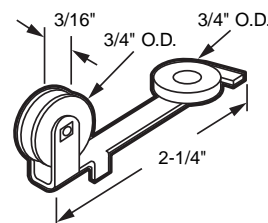

B-577

Spring Tension Roller

Contents: 2 roller assemblies; installation screws.

Description: Nylon wheel with center groove; heat treated, high tension steel spring; one piece spring and housing.

B-577

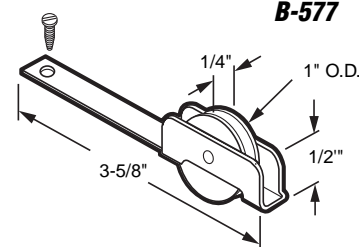

B-649 (Nylon)

B-704 (Steel ball bearing)

Spring Tension Roller

Contents: 2 roller assemblies.

Description: Center grooved wheel with steel housing; high tension steel spring; fits on *Columbia Uni-fit* doors.

You may wish to stock these related parts: A-109, A-163, A-165.

B-649 B-704

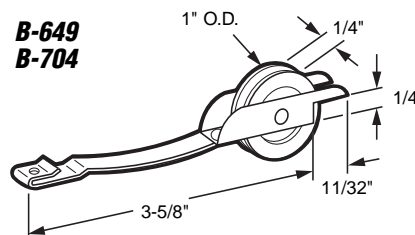

B-655

Spring Tension Roller

Contents: 2 roller assemblies; installation screws.

Description: Nylon wheel with center groove with steel housing; heat treated, high tension steel spring; fits on doors by *Arcadia*.

B-655

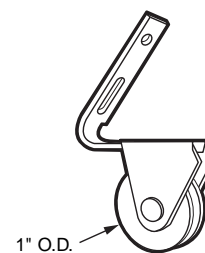

B-659

Roller Assembly

Contents: 2 roller assemblies.

Description: Nylon wheel with aluminum housing; heat treated, high tension steel spring; fits on "old style" *Peachtree* doors.

B-659

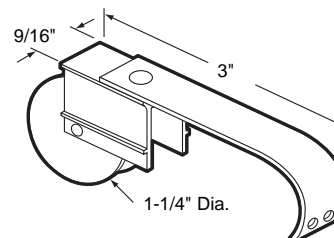

B-531

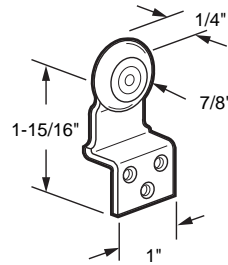

B-531

Roller Assembly

Contents: 2 roller assemblies; installation screws.

Description: Top hung; steel bracket with oval edge nylon wheel; fits on *Arcadia* & *Saurenman* old style steel and aluminum doors.

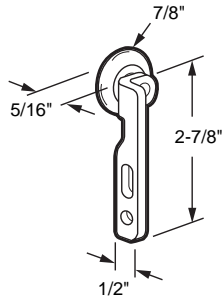

B-532

B-532

Roller Assembly

Contents: 1 left and 1 right hand assembly; installation screws.

Description: Top hung; steel bracket with oval edge nylon ball bearing wheel; used on old style wood sliding screen doors.

You may wish to stock these related parts: **N-6518**, **N-6519**.

B-533

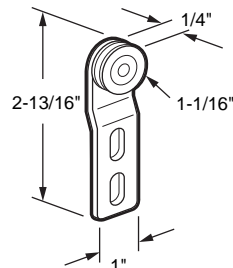

B-533

Roller Assembly

Contents: 2 roller assemblies; installation screws.

Description: Top hung; steel bracket with center groove steel ball bearing wheel; fits on *Premier* doors.

You may wish to stock these related parts: **A-116**, **A-118**, **B-505**.

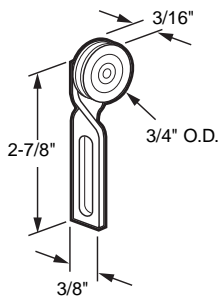

B-534

B-534

Roller Assembly

Contents: 2 roller assemblies; installation screws.

Description: Top hung; steel bracket with center groove steel ball bearing wheel; fits on *Hollyview* doors.

You may wish to stock these related parts: **A-114**, **B-526**.

B-535
B-536

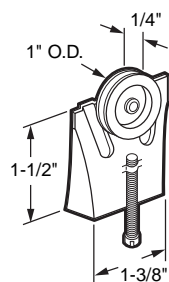

B-535 (Nylon)

B-536 (Steel ball bearing)

Roller Assembly

Contents: 2 roller assemblies.

Description: Top hung; adjustable; steel bracket with center groove wheel; fits on *Ador* doors.

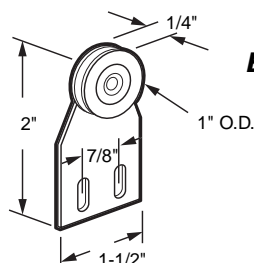

B-537

B-537

Roller Assembly

Contents: 2 roller assemblies; installation screws.

Description: Top hung; aluminum bracket, steel ball bearing wheel with center groove; fits on *Fullview* doors.

You may wish to stock this related part: **B-528**.

Call for
Availability

B-538

Roller Assembly

Contents: 2 roller assemblies; installation screws.

Description: Top hung; 1/16" offset aluminum bracket, steel ball bearing wheel with center groove.

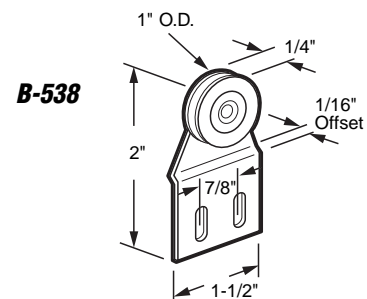

B-539

Roller Assembly

Contents: 2 roller assemblies; installation screws.

Description: Top hung; 1/4" offset steel bracket, steel ball bearing wheel with wide center groove; fits on Ador "Z" doors.

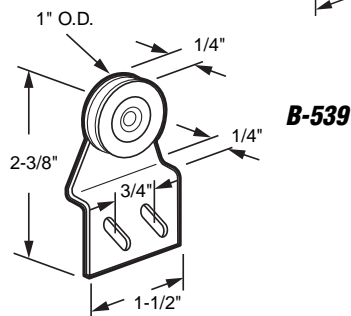

B-540 (Steel ball bearing)

Roller Assembly

Contents: 2 roller assemblies; installation screws.

Description: Top hung; aluminum bracket, wheel with center groove; new style without tabs on bracket will replace old style; fits on Cupples doors.

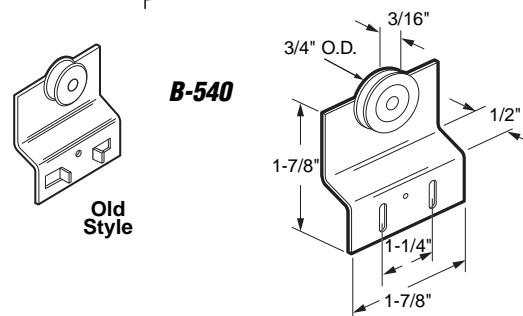

B-627

Roller Assembly

Contents: 2 roller assemblies; installation screws.

Description: Aluminum bracket, oval edge nylon wheel 3/16" wide; top mount; fits on Croft old style doors.

You may wish to stock these related parts: B-626.

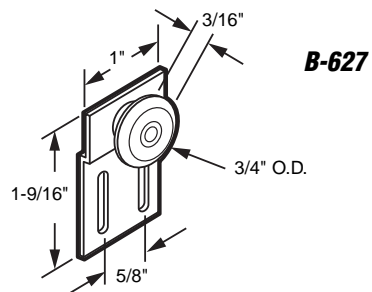

B-542

Roller Assembly

Contents: 2 roller assemblies; installation screws.

Description: Top hung; steel bracket with cone-shaped nylon wheel; fits on HiLite old style doors.

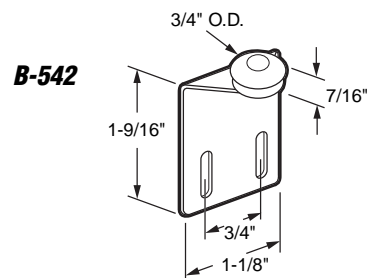

B-543

Roller Assembly

Contents: 2 roller assemblies; installation screws.

Description: Top hung; nylon housing with oval edge nylon ball bearing wheel; built-in guide; fits on HiLite doors.

You may wish to stock these related parts: A-120, B-544.

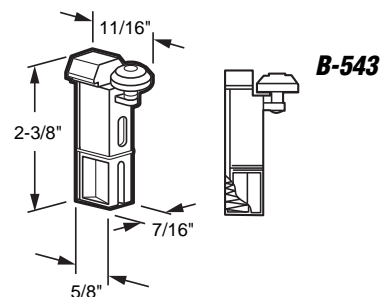

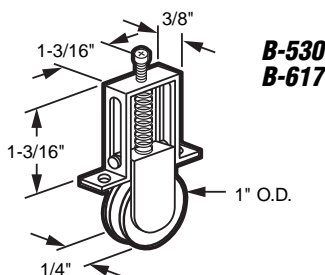
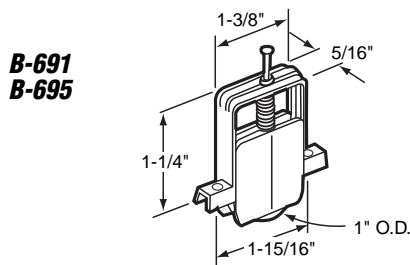
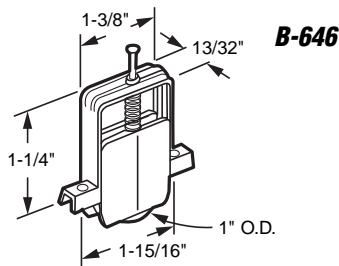
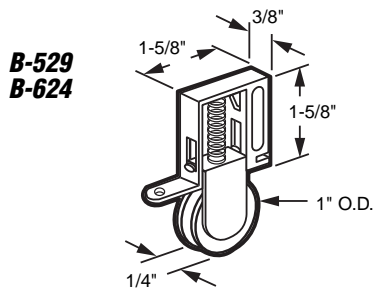
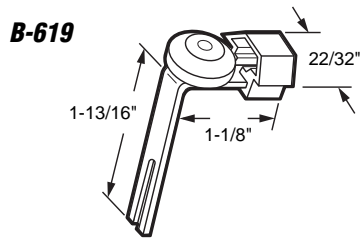
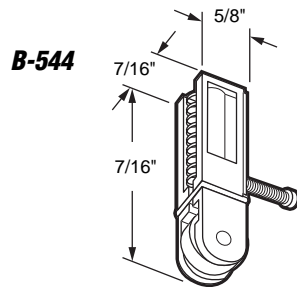

B-544

Roller Assembly

Contents: 2 roller assemblies; installation screws.

Description: Bottom mount; nylon bracket with flat edge, nylon wheel; fits on *HiLite* doors.

You may wish to stock these related parts: **A-120, B-543.**

B-619

Roller Assembly

Contents: 2 roller assemblies; installation screws.

Description: Top hung; steel bracket with oval edge nylon ball bearing wheel; with nylon guide; fits on *Ador/HiLite* doors.

You may wish to stock these related parts: **B-620.**

B-529 (Nylon)

B-624 (Steel ball bearing)

Roller Assembly

Contents: 2 roller assemblies; installation screws.

Description: Nylon housing and yoke; wheel with center groove; spring activated; fits as top and bottom roller on *Academy Uni-fit* doors.

B-646 (Nylon ball bearing)

Roller Assembly

Contents: 2 roller assemblies; installation screws.

Description: Nylon ball bearing wheel and housing with adjustable nylon yoke.

B-691 (Nylon)

B-695 (Steel ball bearing)

Roller Assembly (Thin version)

Contents: 2 roller assemblies; installation screws.

Description: Wheel with center groove; has thinner nylon housing than B-646; fits on doors by *Columbia*.

B-530 (Nylon)

B-617 (Steel ball bearing)

Roller Assembly

Contents: 2 roller assemblies; installation screws.

Description: Aluminum frame with nylon inner housing; adjustable; center grooved wheel; fits as top and bottom roller on *Columbia* doors.

You may wish to stock these related parts: **A-109, A-125, A-163, B-575, B-631.**

Sliding Screen Door

B-575 (Nylon)
B-631 (Steel ball bearing)

Roller Assembly

Contents: 2 roller assemblies.

Description: Nylon main frame assembly; adjustable; nylon inner housing with center grooved wheel; fits as top and bottom roller on *Columbia* doors.

You may wish to stock these related parts: **A-109, A-163, B-530, B-617.**

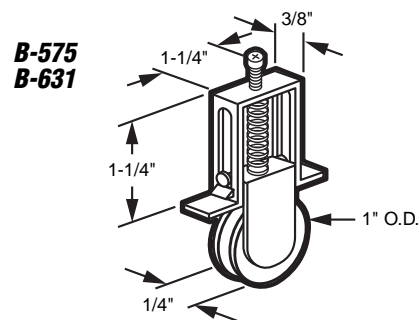

B-684

Roller Assembly

Contents: 2 roller assemblies; installation screws.

Description: Nylon outer housing, aluminum inner housing with center grooved nylon wheel with adjustment cam.

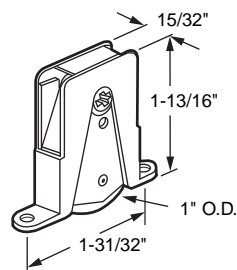

B-684

B-582

Roller Assembly

Contents: 1 roller assembly.

Description: Extruded aluminum housing with adjustment screw; nylon yoke; nylon wheel with center groove.

You may wish to stock this related part: **A-169.**

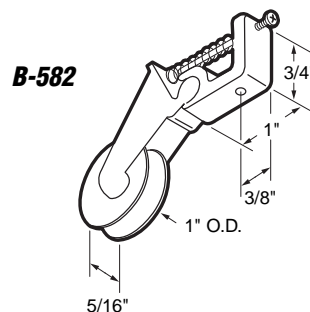

B-582

B-583

Roller Assembly

Contents: 2 roller assemblies.

Description: Extruded aluminum bracket with nylon wheel and housing, center groove wheel, spring activated.

Call for Availability

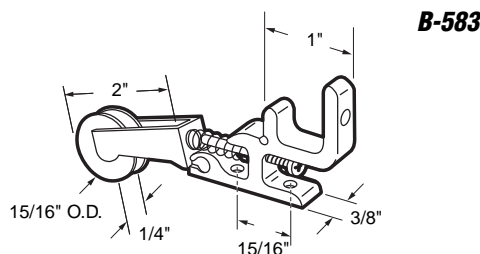

B-583

B-584

Roller Assembly

Contents: 2 roller assemblies; 1 left and 1 right.

Description: Nylon housing with nylon wheel; spring activated.

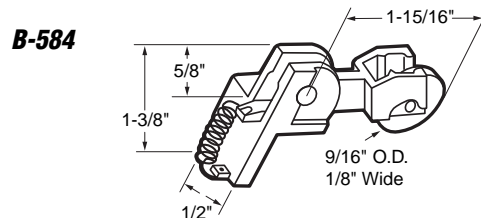

B-584

B-586

Roller Assembly

Contents: 2 roller assemblies.

Description: Extruded aluminum housing, nylon wheel with narrow center groove; with adjusting screw; fits on doors by *Miller Door.*

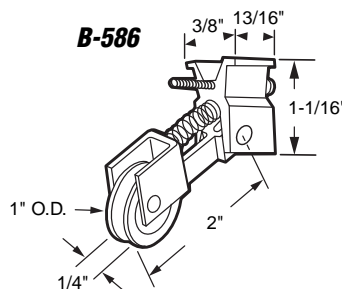

B-586

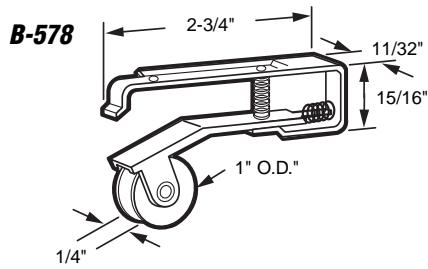

B-578

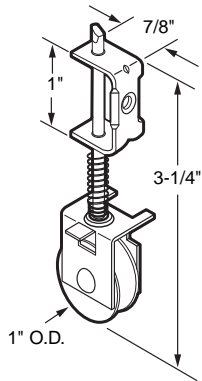

B-588

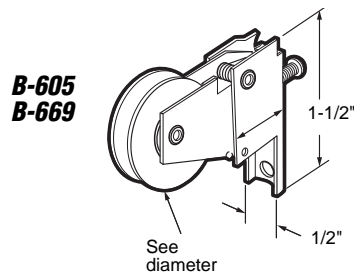

**B-605
B-669**

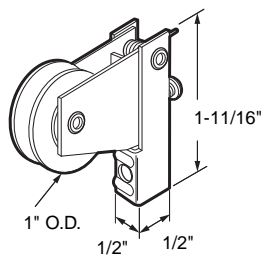

B-606

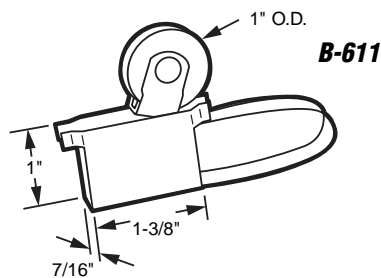

B-611

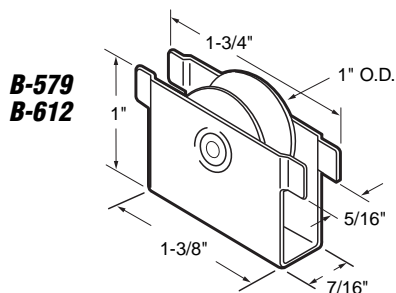

**B-579
B-612**

B-578

Roller Assembly

Contents: 2 roller assemblies; installation screws.

Description: Aluminum housing with stainless steel spring; 1" nylon wheel with center groove; built-in screw adjustment feature; used by many door manufacturers.

You may wish to stock these related parts: **B-647**.

B-588

Roller Assembly

Contents: 2 roller assemblies.

Description: Steel housing with nylon wheel; spring activated; fits on doors by *Crossly*.

B-605 (1" nylon ball bearing)

B-669 (7/8" steel ball bearing)

Roller Assembly

Contents: 2 roller assemblies.

Description: Adjustable, steel housing; ball bearing wheel with center groove; spring activated; fits on doors by *Pacesetter*.

B-606

Roller Assembly

Contents: 2 roller assemblies.

Description: Steel housing with nylon wheel; spring activated; fits on doors by *Peachtree*.

B-611

Roller Assembly

Contents: 2 roller assemblies.

Description: Steel roller housing, nylon ball bearing wheel with center groove; heat treated, high tension steel spring; fits as a top roller on *Better-Bilt* doors.

You may wish to stock these related parts: **B-579, B-612**.

B-579 (Nylon)

B-612 (Steel ball bearing)

Roller Assembly

Contents: 2 roller assemblies.

Description: Steel housing; wheel with center groove; bottom roller on *Empire and Better-Bilt* adjustable sliding screen doors.

You may wish to stock these related parts: **A-139, B-611**.

Sliding Screen Door

B-701 (Nylon)
B-702 (Steel)

Roller Assembly

Contents: 2 roller assemblies.

Description: Spring loaded, **steel housing** with top adjusting screw; fits on doors by **Bay-Mills** and other door manufacturers.

B-618

Roller Assembly

Contents: 2 roller assemblies.

Description: **Galvanized steel housing**, **nylon roller**, **nylon swivel mounting bracket**, high tension **steel spring** fits on doors by **Ador/HiLite**.

Call for
Availability

B-641 (Nylon)
B-679 (Steel ball bearing)

Roller Assembly

Contents: 1 roller assembly; installation screws.

Description: Adjustable, **aluminum housing**; wheel with center groove; spring activated; adjustment screw and **aluminum sleeve**.

B-645 (Nylon ball bearing)
B-683 (Steel ball bearing)

Roller Assembly

Contents: 2 roller assemblies; installation screws.

Description: Adjustable, **nylon housing**; wheel with center groove; fits on doors by **Peachtree**.

You may wish to stock these related parts: **B-656**.

B-656

Roller Assembly

Contents: 2 roller assemblies; installation screws.

Description: Adjustable **steel housing**; **steel ball bearing wheel** fits on doors by **Peachtree**.

B-647 (Nylon)
B-682 (Steel ball bearing)

Roller Assembly

Contents: 2 roller assemblies.

Description: **Nylon housing**; center grooved wheel; with adjustable **aluminum yoke**; fits on doors by **Metal Industries**.

You may wish to stock these related parts: **B-578**.

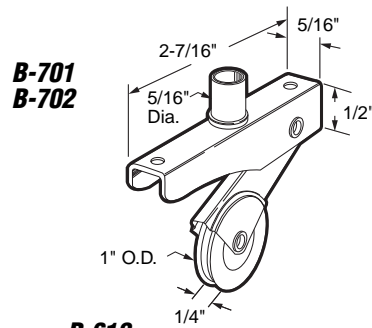

B-701
B-702

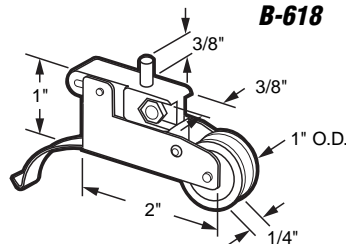

B-618

B-641
B-679

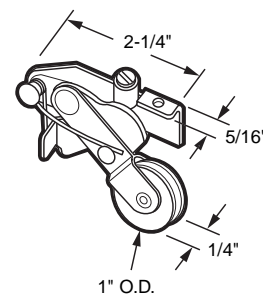

B-645
B-683

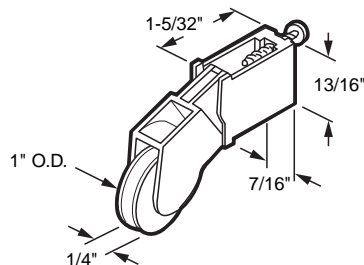

B-656

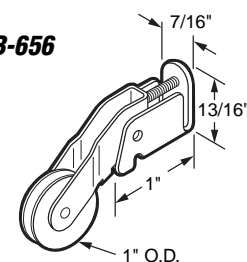

B-647
B-682

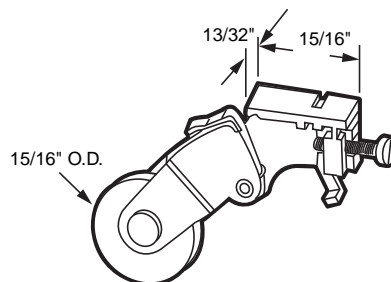

B-694

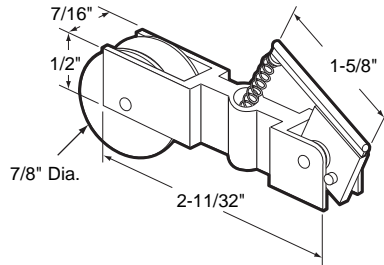

B-663

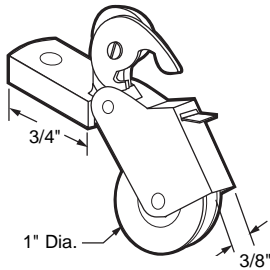

B-665

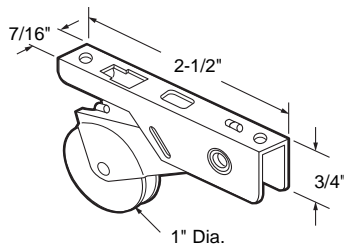

B-668

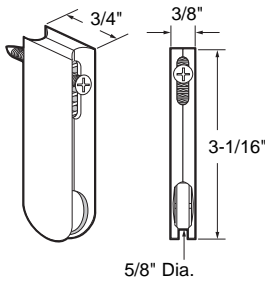

B-692

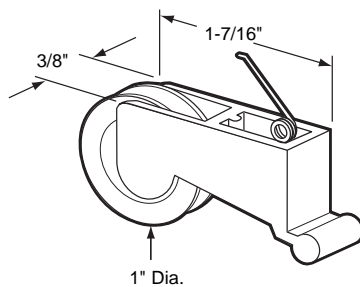

B-585

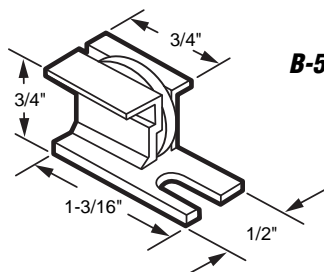

B-694

Roller Assembly

Contents: 2 roller assemblies.

Description: Nylon housing; with center grooved nylon wheel; fits on *Ozark and Chrysler* windows.

B-663

Roller Assembly

Contents: 2 roller assemblies; 1 left and 1 right.

Description: Steel ball bearing wheel; adjustable diecast mounting bracket with stamped steel housing.

B-665 (Steel ball bearing)

Roller Assembly

Contents: 2 roller assemblies.

Description: Stainless steel housing; with steel center grooved wheel; spring activated; adjusting screw; fits on doors by *Metal Industries*.

B-668

Roller Assembly

Contents: 2 roller assemblies; installation screws.

Description: Nylon housing and flat nylon wheel; with steel spring; fits on *Weathershield* doors.

B-692 (Nylon)

Roller Assembly

Contents: 2 roller assemblies.

Description: Nylon housing with center grooved wheel; spring activated.

B-585

Roller Assembly

Contents: 2 roller assemblies; 1 left and 1 right.

Description: Nylon housing with 1/8" thick, 3/4" diameter flat nylon wheel; fits on *Howard* doors.

Call for
Availability

B-547

Roller Assembly

Contents: 2 roller assemblies; installation screws.

Description: Adjustable; nylon housing with center groove, steel ball bearing wheel; bottom mount.

B-547

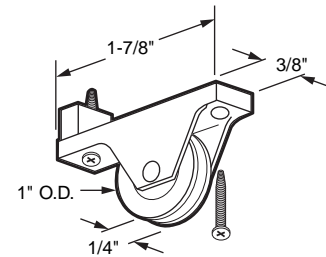

B-580

Roller Assembly

Contents: 2 roller assemblies; installation screws.

Description: Extruded aluminum housing with top support plate; nylon wheel with narrow center groove; fits on *Daryl PM* doors.

Call for Availability

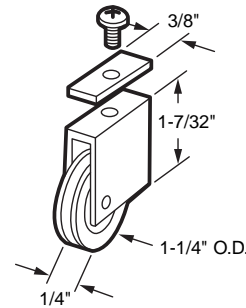

B-580

B-581

Roller Assembly

Contents: 2 roller assemblies; installation screws.

Description: Extruded aluminum housing, nylon wheel with narrow center groove; designed for *Daryl PM* doors.

B-581

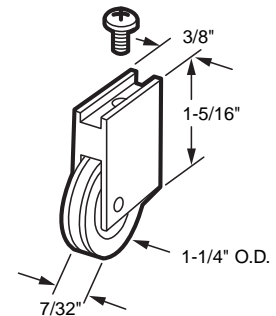

B-587

Roller Assembly

Contents: 2 roller assemblies; installation screws.

Description: Extruded aluminum housing with nylon wheel; narrow center groove with one side of the wheel a larger diameter than the other.

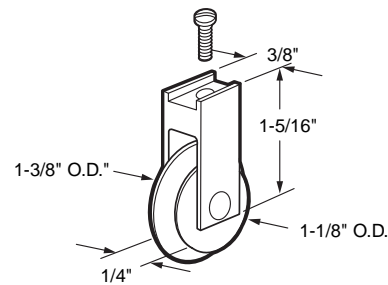

B-587

B-604

Roller Assembly

Contents: 1 roller and corner assembly.

Description: Stamped aluminum corner; center grooved nylon wheel; adjusting screw; fits on doors by *Jim Walters*.

You may wish to stock these related parts: **A-150**, **A-151**.

B-604

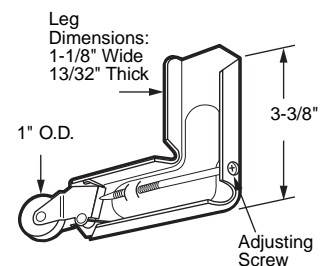

B-607

Roller Assembly

Contents: 1 roller and corner assembly.

Description: Stamped galvanized steel corner housing with center-grooved nylon wheel; spring activated; adjusting screw; fits on doors by *Metal Industries*.

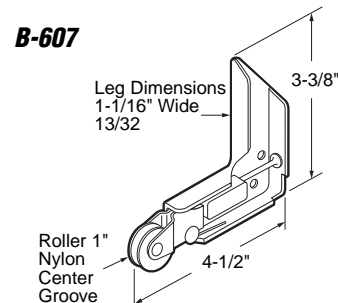

Call for
Availability

B-650
B-651
B-657

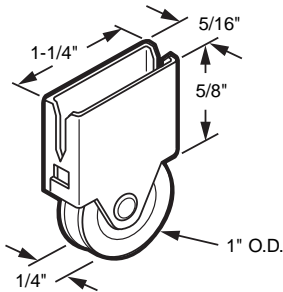
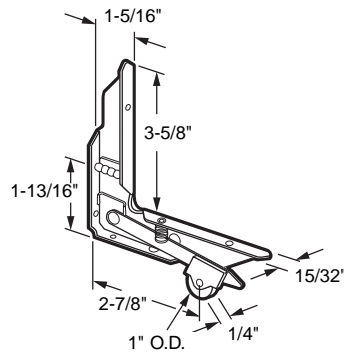

B-652
B-696

B-548

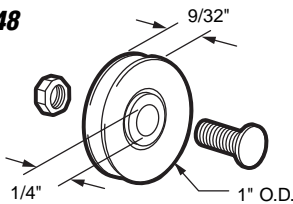

B-549
B-550

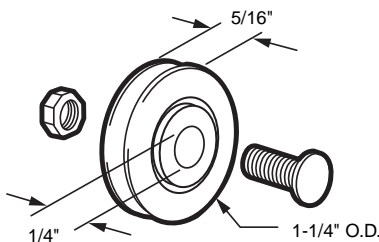

B-551

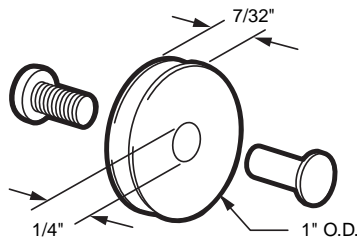

B-552

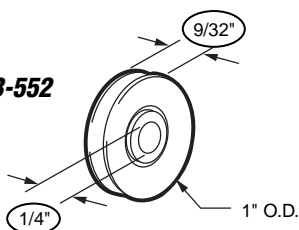

B-697

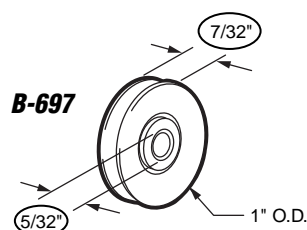

B-650 (Left hand)

B-651 (Right hand)

B-657 (Combination pack of B-650 and B-651)

Roller Assembly

Contents: 1 roller assembly.

Description: Stamped steel corner housing with nylon wheel.

Note: B-657 contains 1 pair (left & right).

You may wish to stock these related parts: **A-163, A-165, B-652.**

B-652 (Nylon)

B-696 (Steel ball bearing)

Roller Assembly

Contents: 2 roller assemblies.

Description: Stamped steel housing; grooved wheel; a replacement roller insert for B-650 and B-651 corner assemblies.

You may wish to stock these related parts: **A-109, A-163, A-165.**

B-548

Roller Assembly

Contents: 2 rollers; with fasteners.

Description: Steel ball bearing roller; with 1/4" hole; center grooved; used by many door manufacturers.

B-549 (Steel ball bearing)

B-550 (Nylon ball bearing)

Roller Assembly

Contents: 2 rollers; with fasteners.

Description: Ball bearing roller with 1/4" hole; center grooved; used by many door manufacturers.

B-551

Roller Assembly

Contents: 2 rollers; with fasteners.

Description: Nylon wheel with narrow center groove; fits on *Air Control* doors.

B-552 (Nylon)

B-697 (Steel ball bearing)

Roller

Contents: 2 rollers.

Description: Center grooved nylon or steel ball bearing roller; used by many door manufacturers.

B-553

Roller Assembly

Contents: 2 roller assemblies; with fasteners.

Description: Nylon wheel with; nylon bushing; bottom mount.

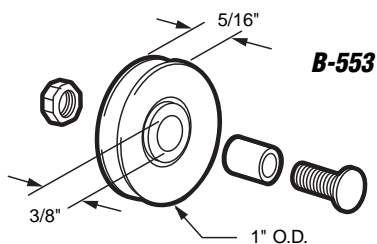

B-707

Roller Assembly

Contents: 2 rollers.

Description: Nylon ball bearing wheel with center groove; repair part for B-645 roller.

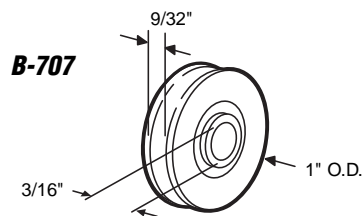

B-554

Roller Assembly

Contents: 2 roller assemblies; with fasteners.

Description: Nylon wheel with narrow offset groove; nylon bushing; bottom mount.

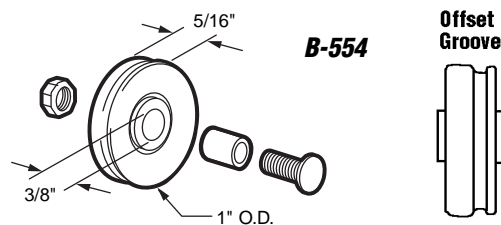

B-555 (Center groove)

B-556 (Narrow offset groove)

Roller Assembly

Contents: 2 roller assemblies; with fasteners.

Description: Nylon wheel with; nylon bushing; bottom mount.

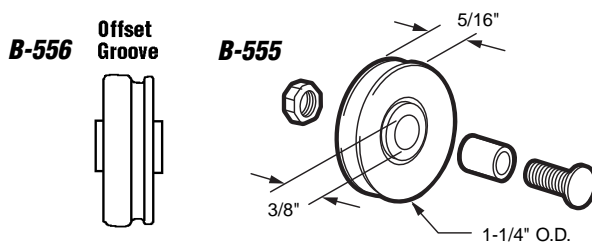

B-557 (Narrow center groove)

B-558 (Medium center groove)

Roller Assembly

Contents: 2 roller assemblies; with fasteners.

Description: Nylon wheel; with threaded steel bushing; bottom mount.

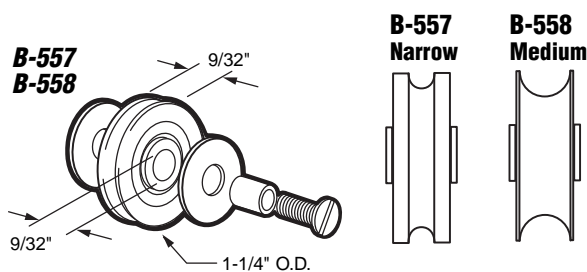

B-559

Roller Assembly

Contents: 2 roller assemblies; with fasteners, nylon spacers and 2 wire tension springs.

Description: Adjustable, nylon wheel with wide center groove; spring loaded.

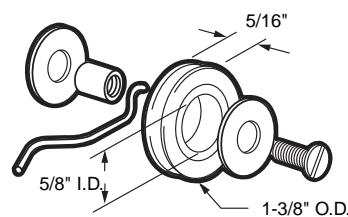

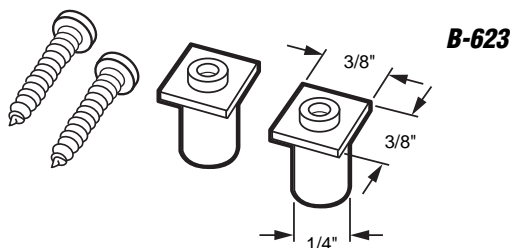
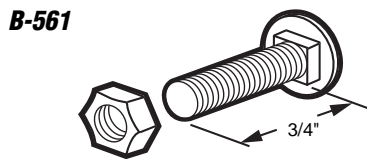
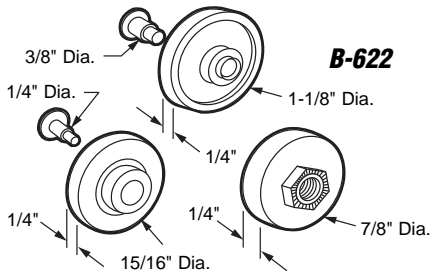
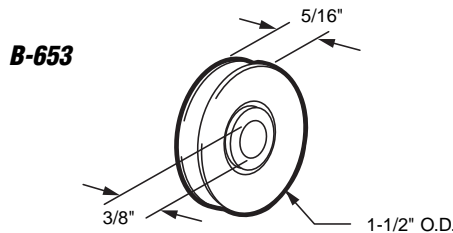
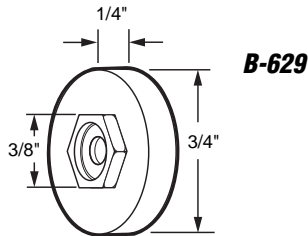
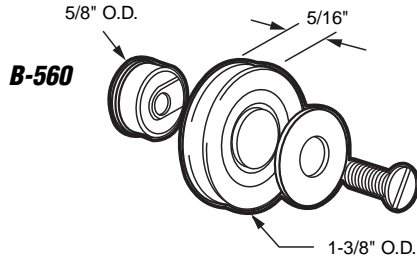

B-560

Roller Assembly

Contents: 2 roller and hub assemblies; with fasteners.

Description: Adjustable, nylon wheel with aluminum internally threaded hub; wide center groove; bottom mount; fits on *Arcadia* doors.

You may wish to stock these related parts: **B-520**.

B-629

Roller Assembly

Contents: 2 rollers; with fasteners.

Description: Threaded hex hub; 3/4" flat nylon ball bearing wheel; fits *Croft* and *Keller* doors.

You may wish to stock these related parts: **A-122; B-628; B-630**.

B-653

Roller

Contents: 2 rollers.

Description: Nylon wheel; with center groove; bottom mount.

Call for Availability

B-622

Roller Assortment

Contents: 3 pair of rollers.

Description: 2 each 7/8" flat edge nylon ball bearing wheels with threaded inner race and machine screws; 2 each 15/16" flat edge nylon wheels with aluminum rivet; 2 each 1-1/8" flat edge nylon wheels with aluminum rivet.

B-561

Bolt Assembly

Contents: 4 - 1/4"-20 x 3/4" flat head carriage bolts; with hex nuts.

Description: Used with most bottom mount rollers having a 1/4" inside diameter.

B-623

Roller Adjustment Kit

Contents: 4 nylon sleeves; with fasteners.

Description: Adjustment screws and sleeves fit on *Anjac* style spring tension rollers; 7/16" length under head.

You may wish to stock these related parts: **B-512; B-513; B-570; B-571**.

Sliding Screen Door

B-563

Top Guide

Contents: 4 guides; with fasteners.

Description: Plastic guide; with attaching screw; fits on *Mayfair* doors.

You may wish to stock these related parts: **B-511**.

B-599

Top Guide

Contents: 2 guides.

Description: Nylon top guides; fits on *Pan Am* doors.

Call for
Availability

B-562

Top Guide

Contents: 4 guides.

Description: Nylon guide; acts as guide and anti-rattle device; used by many door manufacturers.

Call for
Availability

B-573

Top Guide

Contents: 4 guides; with fasteners.

Description: Nylon guide; adjustable; used by many door manufacturers.

B-597

Top Guide

Contents: 2 guides; with springs and adjustment screws.

Description: Nylon top guides; fits on *Tucker* doors.

B-633

Top Guide

Contents: 4 guides.

Description: Nylon guide; fits on *Columbia* screen doors as a top guide and anti-rattle device.

You may wish to stock these related parts: **A-109, A-159, A-160, A-165, A-172**.

B-563

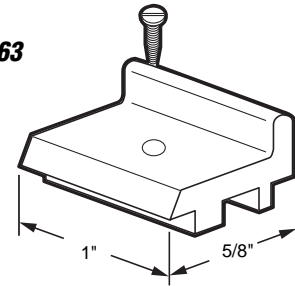

B-599

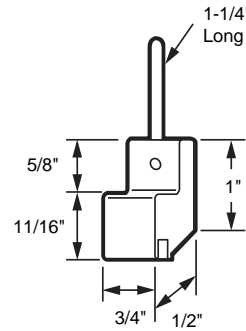

B-562

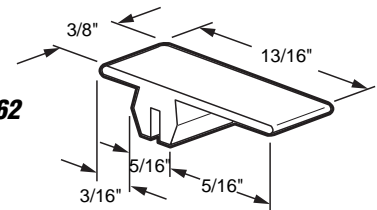

B-573

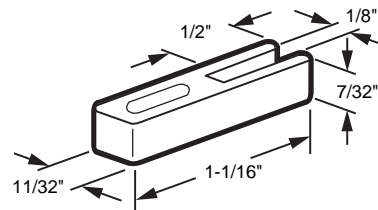

B-597

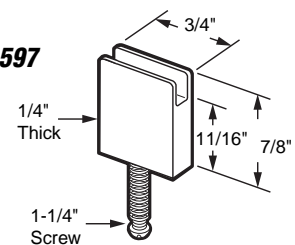

B-633

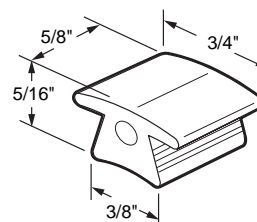

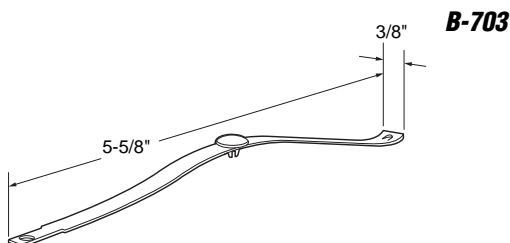
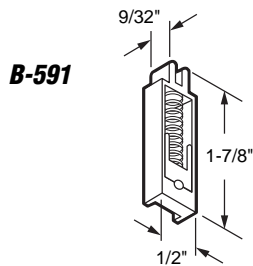
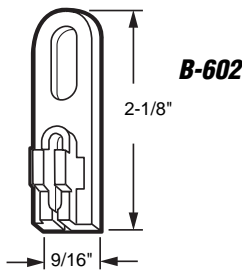
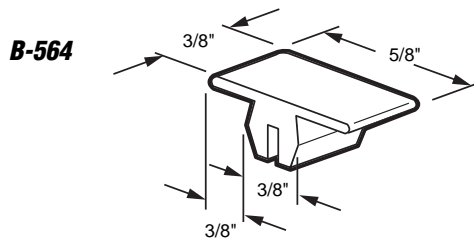
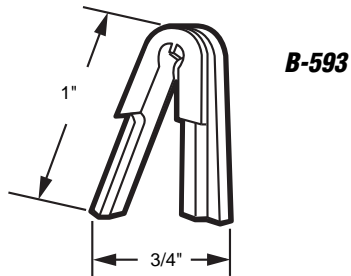
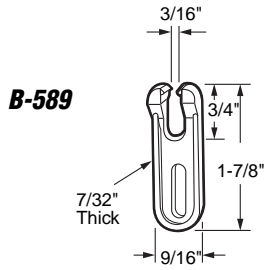

B-589

Top Guide

Contents: 2 guides.

Description: Nylon guide; fits on *Crossly* doors.

B-593

Top Guide

Contents: 4 guides.

Description: Nylon guide; fits on *Miller* doors.

You may wish to stock these related parts: **B-586**.

B-564

Top Guide

Contents: 2 guides.

Description: Plastic guide; acts as guide and anti-rattle device; used by many door manufacturers.

B-602

Top Guide

Contents: 2 guides.

Description: Nylon guide; fits on *Crossly* doors.

B-591

Top Guide

Contents: 2 guides.

Description: Nylon guide with adjustment spring; fits on *Daryl PRI* doors.

B-703

Top Tension Spring

Contents: 2 springs.

Description: Top mounted heat treated, high tension steel spring with nylon glide button.

Sliding Screen Door

B-545

Bottom Guide

Contents: 2 guides; installation screws.

Description: Nylon spring loaded assembly; bottom mount; fits on *Ador* doors.

B-546

Bottom Guide

Contents: 2 guides and installation screws.

Description: Bottom mount; aluminum housing with nylon spring loaded guide; fits on *Ador "Z"* doors.

B-595

Guide

Contents: 2 guides.

Description: Nylon guide fits on *Tucker* doors.

B-598

Bottom Guide

Contents: 2 guides.

Description: Nylon bottom guide with adjustment spring and screw; fits on *Tucker* doors.

B-601

Bottom Guide

Contents: 2 guides.

Description: Nylon bottom guide with spring and cap nut.

B-620

Spring Tension Guide

Contents: 2 guide assemblies.

Description: Bottom mount; heat treated, high tension steel spring; nylon guide; fits on *Ador/Hilite* doors.

Call for
Availability

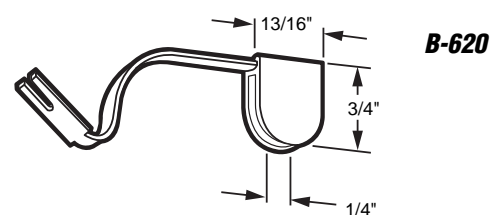
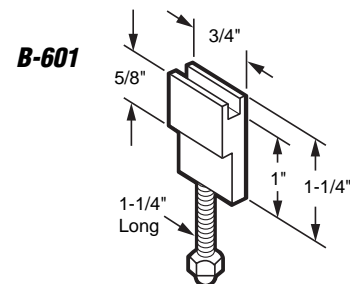
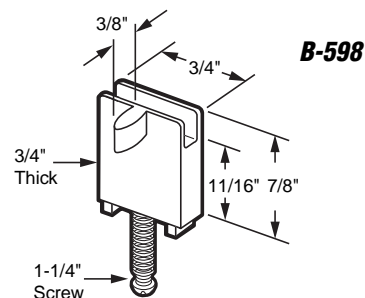
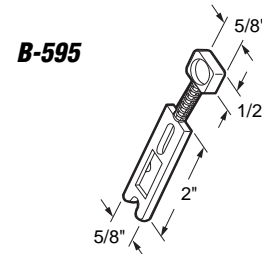
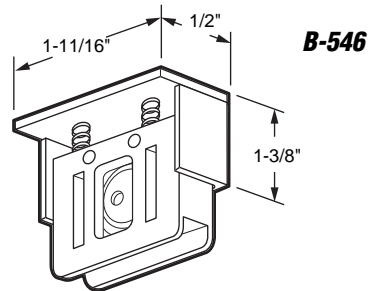
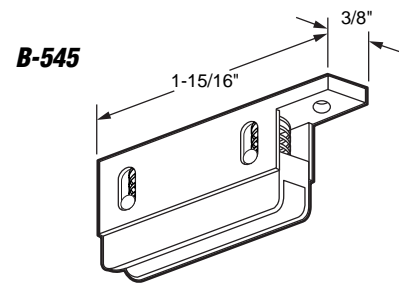

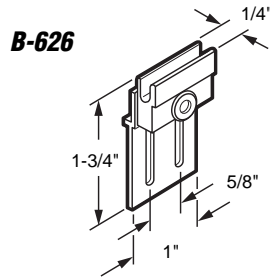

B-626

Bottom Guide

Contents: 2 guides; 2 sets installation screws.

Description: Aluminum bracket with nylon guide; bottom mount; fits on *Croft* old style doors.

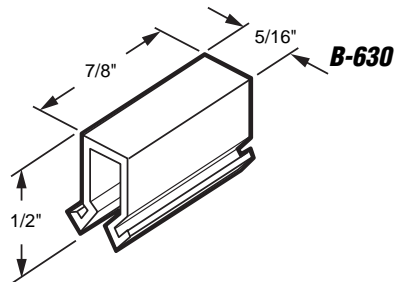

B-630

Bottom Guide

Contents: 4 guides.

Description: Black plastic bottom guide; prevents excessive wear on door frame; fits on doors by *Keller Industries*.

You may wish to stock these related parts: **B-629**.

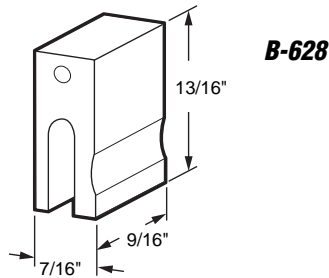

B-628

Bottom Guide

Contents: 2 guides; installation screws.

Description: Rigid vinyl guide; bottom mount; fits on *Croft* series 701 and 702 doors.

You may wish to stock these related parts: **B-629**.

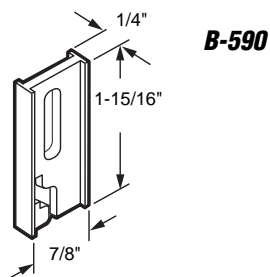

B-590

Bottom Guide

Contents: 2 guides.

Description: Nylon bottom guide; fits on *Crossly* doors.

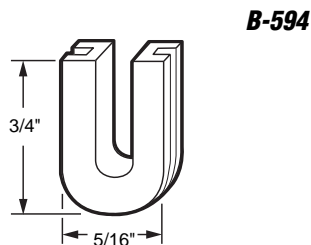

B-594

Bottom Guide

Contents: 2 guides.

Description: Nylon guide; fits on *Daryl* doors.

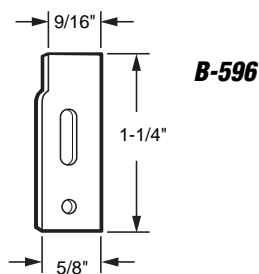

B-596

Bottom Guide

Contents: 2 guides.

Description: Nylon guide; fits on *Tucker* doors.

Sliding Screen Door

B-603

Guide

Contents: 2 guides.

Description: Nylon guides used to prevent wear on door frame.

B-603

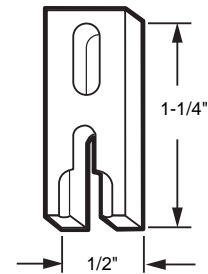

B-569

Corner Insert

Contents: 2 corners.

Description: Diecast plain finish with adjustment screw; for 45° miter cut door design; used by many door manufacturers.

You may wish to stock these related parts: **B-514, B-515, B-610, B-636.**

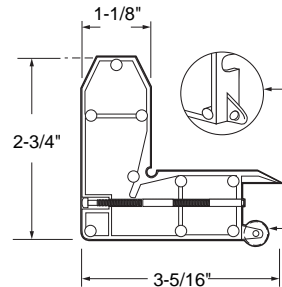

B-569

B-642

Corner Insert

Contents: 2 corners.

Description: Diecast plain finish; for 45° miter cut door design; used by many door manufacturers.

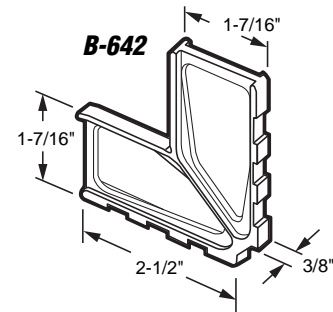

B-642

Call for
Availability

B-613 (Clear - 84")

B-614 (Clear - 96")

B-615 (Black - 84")

B-616 (Black - 96")

Uni-Fit Bug Seal

Contents: 5 each per master box.

Description: Clear or black anodized aluminum molding; 1-1/4" wide vinyl flap is segmented into 1/4" strips you can tear to desired size; pre-punched for screws; easy to install to both roll-formed or extruded door frames.

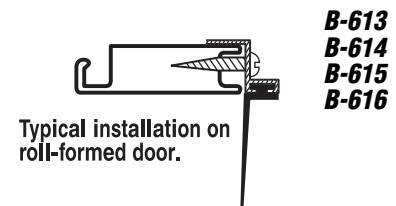

Typical installation on roll-formed door.

**B-613
B-614
B-615
B-616**

B-621 (7 ft. long - Black vinyl)

B-658 (8 ft. long - Black vinyl)

Bug Seal

Contents: 1 strip of vinyl.

Description: Vinyl flap has tear strips to adjust width from 7/8" to 1-3/8"; flexible; seals against insects.

**B-621
B-658**

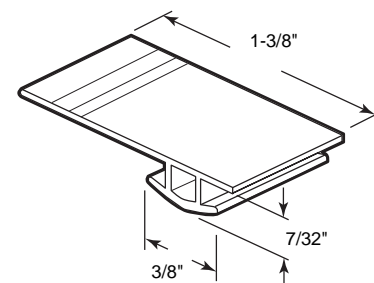

B-660 (7 ft. long - Black vinyl)

Bug Seal

Contents: 1 strip of vinyl.

Description: Vinyl flap has tear strips to adjust width from 7/8" to 1-3/8"; flexible; seals against insects.

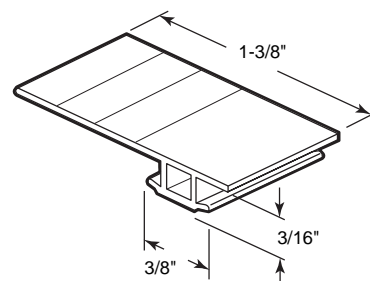

B-660

B-705

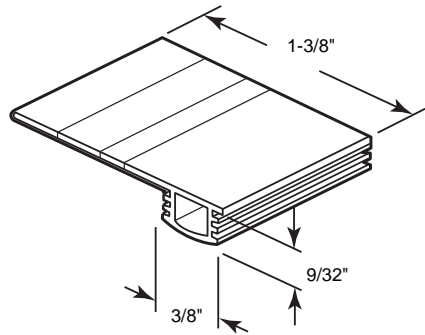

B-705 (7 ft. long - Black vinyl)

Bug Seal

Contents: 1 strip of vinyl.

Description: Vinyl flap has tear strips to adjust width from 3/4" to 1-3/8". Flexible, seals against insects.

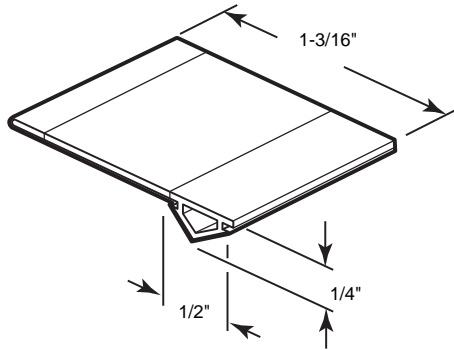

B-708

B-708 (7 ft. long - Black vinyl)

Bug Seal

Contents: 1 strip of vinyl.

Description: Vinyl flap has tear strips to adjust width from 9/16" to 1-3/16"; flexible; seals against insects; fits *International* on series No. 900, 925, 950, doors.

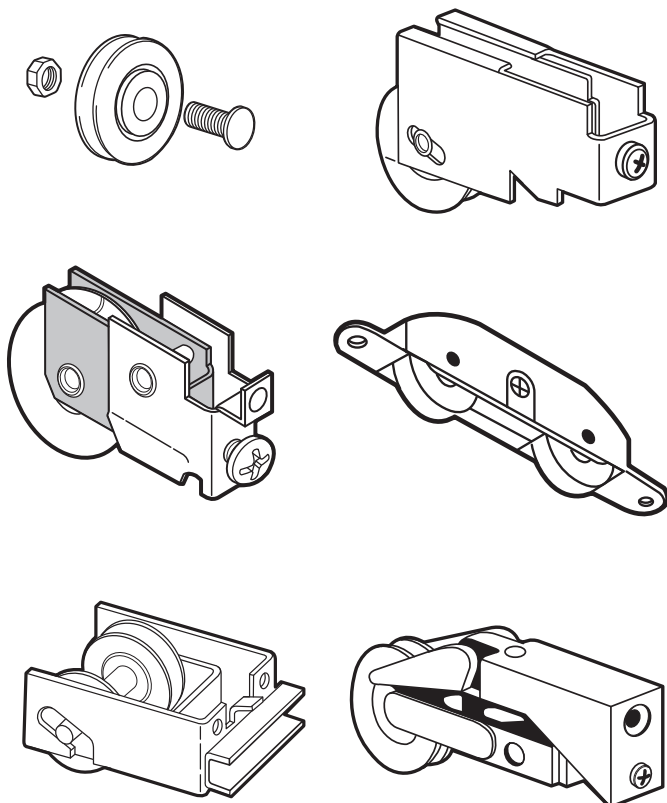

**See our huge
selection of
Patio Door rollers
and
roller assemblies.**